

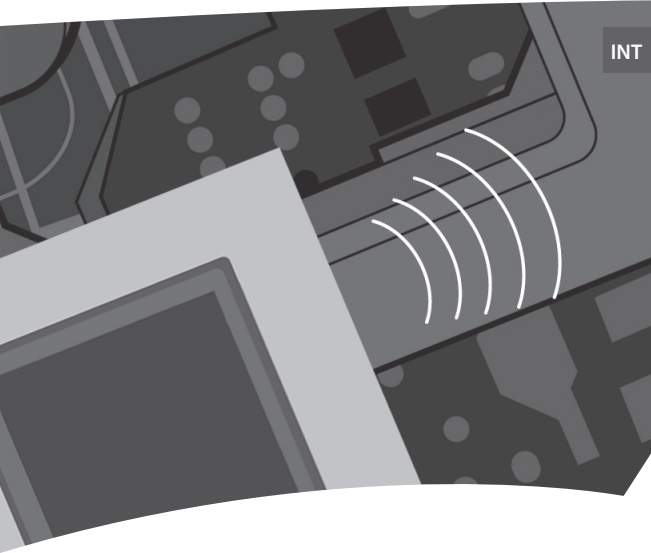

INT

An abstract graphic in shades of gray and white, featuring geometric shapes, lines, and concentric arcs that suggest a floor plan or a technical diagram. The graphic is divided into two main sections by a curved line.

# **Danfoss Link™ FT Floor Thermostat**

## **Installation Manual**

## Danfoss Link™ FT

The Danfoss Link™ FT (Floor Thermostat) is a device for switching the heating element ON/OFF. In connection with a floor sensor it can also measure the temperature in the floor (FTS). Secondly you have the possibility to use the FT as a on and off switch to other equipments manually or by schedule.

Installation scenario:

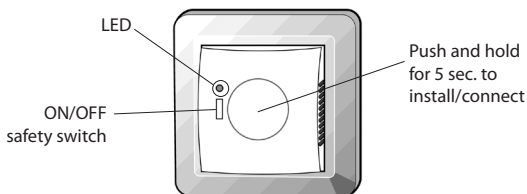
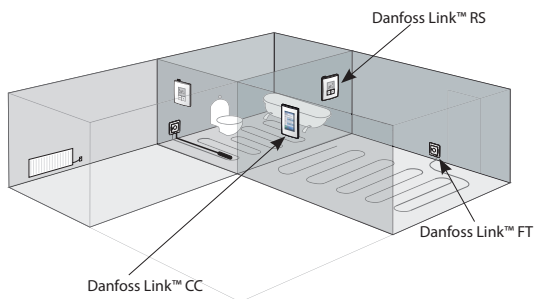

# Placement of Danfoss Link™ FT

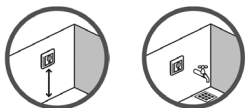

Installation and placement must be according to local building regulations.

## Operation mode

Danfoss Link™ FT supports two types of operation modes.

1. Heating regulation
2. On/OFF switching

When used in heating regulation mode you have to consider the following advices for controlling the heating.

When used as simple ON/OFF mode do not connect floor sensor.

## Sensor combination

When installing the Danfoss Link™ FT you need to consider the type of heating and thus which sensors should be used. There are three options:

- 1. Comfort heating:** Constant temperature on the floor in bathrooms and other rooms where a comfortable warm surface is required. Install the Floor sensor and choose Floor regulation for the room when doing the configuration.
- 2. Total heating:** Control of room temperature in living rooms etc. Install the floor sensor and a Danfoss Link™ RS. Choose Combined regulation when doing the configuration on the Danfoss Link™ CC.
- 3. No floor sensor:** A floor sensor is not present, and cannot be installed. You must install a Danfoss Link™ RS. Choose Room regulation.

## *Placement of Danfoss Link™ FT*

Be aware that temperature control is less accurate without the floor sensor and that all Danfoss Link™ FTs in a room need to have the same sensor configuration.

Danfoss recommends always installing a floor sensor.

**Do not install floor heating system without a floor sensor when the heating element is installed on or beneath wooden surfaces and other surfaces sensitive to temperature!**

# Installation of Danfoss Link™ FT

## Installation of Danfoss Link™ FT

1. To remove the front cover, gently press the release tabs under the bottom of the thermostat with a screwdriver. Then remove the front.

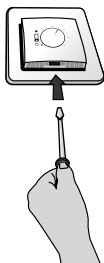

2. Connect the thermostat according to the connection diagram.

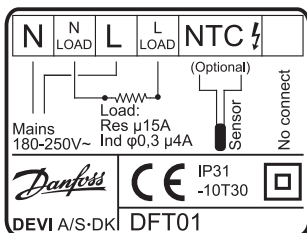

## Configuration:

See Step-by-Step guide in Danfoss Link™ CC instruction manual.

## *Trouble shooting*

Green LED ON	Standby
Red LED ON	Heating
Green LED fast flash	Inclusion or link test
Red LED short flash	Inclusion not OK, goes to not included. Linktest not OK, goes to missing link
RED LED slow flash	Sensor failure

### **Factory reset a Danfoss Link™ FT**

Turn off power on the safety switch on the front. Hold the install button in while pushing ON the safety switch and keep the install button pressed until the LED gives a red flash (approx. 5 sec.)

## *Disposal Instruction*



## Technical specifications

<b>Operation voltage</b>	180-250 VAC, 50/60 Hz
<b>Standby power consumption</b>	Max. 1 W
<b>Relay:</b> <ul style="list-style-type: none"> <li>• Resistive load</li> <li>• Inductive load</li> </ul>	230 V ~ 15 A / 3450 W $\cos \phi = 0.3$ Max. 4 A
<b>Sensing unit</b>	NTC 15kOhm AT 25°C
<b>Sensing values:</b> <ul style="list-style-type: none"> <li>• 0°C</li> <li>• 20°C</li> <li>• 50°C</li> </ul>	42 kOhm 18 kOhm 6 kOhm
<b>Regulation</b>	PWM
<b>Ambient temperature</b>	-10° to +30°C
<b>Sensor failure monitoring</b>	The thermostat has a built-in monitoring circuit, which will switch off the heating if the sensor is disconnected or short-circuited
<b>Transmission frequency</b>	868.42 MHz
<b>Transmission range in normal buildings</b>	Up to 30 m
<b>Transmission power</b>	Max. 1 mW
<b>IP class</b>	31
<b>Dimensions</b>	85 mm × 85 mm × 21 mm





## *The 2 Year Danfoss Warranty*

You have purchased a Danfoss heating system which we are sure will serve to improve the comfort and economy of your application.

Danfoss provides superior electrical heating solutions for total climate control in and around homes and buildings. Danfoss offers a complete product program with Danfoss heating cables or Danfoss heating mats, Danfoss thermostats, Danfoss selflimiting heating cables combined with additional products completing the product program.

This 2 year warranty applies to all Danfoss products.

Should you, against all expectations, experience a problem with your Danfoss product, you will find that Danfoss offers a 2 year warranty from the date of purchase on the following conditions:

During the warranty period Danfoss shall offer a new comparable product or repair the product in case the product is found to be faulty by reason of defective design, materials or workmanship. Repair or replacement shall be carried out at Danfoss' discretion. Danfoss shall not be liable for any consequential or incidental damages including, but not limited to, damages to property or extra utility expenses.

This warranty shall only be valid on production of proof of purchase and must be submitted to the installer or seller without undue delay.

An extension of the warranty period following repairs undertaken under warranty cannot be granted. The Danfoss Warranty shall not cover any damage caused by incorrect conditions of use, incorrect installation or if installation has been carried out by non-authorised electricians. All work will be invoiced in full if Danfoss is required to inspect or repair faults that have arisen as a result of any of the above.

The Danfoss Warranty shall not extend to equipment which has not been paid in full.

Danfoss will, at all times, provide a rapid and effective response to all complaints and inquiries from our customers.

The warranty explicitly excludes all claims exceeding the above conditions.

## *The 2 Year Danfoss Warranty*

# Warranty Certificate

**The Danfoss™ Warranty is granted to:**

Name:

---

Address

---

City:

Country:

Telephone:

---

### Attention:

The Warranty Certificate must be completed correctly for the Warranty to be valid.  
Please read the Warranty conditions above.

Type of thermostat:

Electrical installation by:

---

Article number:

Date:

---

Suppliers Stamp:



Article No.: 088L8083

Version - 02.01

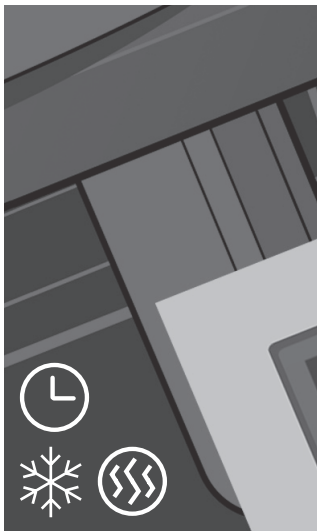

Danfoss A/S  
DK • 7100 Vejle  
Phone +45 7488 8500  
Fax +45 7488 8501

Danfoss can accept no responsibility for possible errors in catalogues, brochures and other printed material. Danfoss reserves the right to alter its products without notice. This also applies to products already on order provided that such alterations can be made without subsequent changes being necessary in specifications already agreed.  
All trademarks in this material are property of the respective companies. Danfoss and the Danfoss logotype are trademarks of Danfoss A/S. All rights reserved.